

Caravaggio

OVEN

Installation manual



This oven has been designed with the utmost care and undergone rigorous tests in our laboratories and for this reason we guarantee its absolute safety and functionality.

The installation must be carried out by **professionally qualified** staff, that can take responsibility for the installation and guarantee the best safe operating conditions.

Before the installation, read the content of this manual **carefully**: it contains important information regarding product assembly and safety regulations.

Technical service

The Manufacturer can solve any technical problem regarding installation.
Do not hesitate to contact him in case of doubt.

CUPPONE 1963
Cuppone F.lli S.r.l.
Via Sile, 36
31057 Silea (TV) - ITALY
T +39 0422 361143
F +39 0422 360993
info@cuppone.com - www.cuppone.com

Introduction 3

Technical service.....3

Contents 3

Safety instructions 4

Symbols used in the manual4

Installation 5

Transport5

Preliminary operations.....5

Positioning5

Serial number plate reading7

Smoke extraction.....7

Electrical connection.....8

Pre-testing and final inspection.....15

Checking the operation.....15



- Read this guide carefully before installing the appliance, and keep it with care in an accessible place for any future consultation by the various operators.
- Moreover, the manual must always accompany the product through its life, even in case of transfer.
- Before any movement or installation, check that the room is suitable and systems comply with the installation country standards and the specifications indicated on the appliance rating plate.
- All installation, assembly and non-routine maintenance operations must be performed exclusively by qualified technicians that are authorised by the Manufacturer, in compliance with the regulations in force in the user country, and with the regulations on systems and work safety.
- Before performing any installation or maintenance, disconnect the electricity supply.
- Unauthorised actions, tampering or modifications that do not follow the information provided in this manual can cause damages, injuries or fatal accidents and null and void the warranty.
- It is forbidden to install the oven in environments at risk of explosion.
- Installation or maintenance that fails to comply with the instructions in this manual may cause damage, injury or fatal accidents.
- Persons not involved with the appliance installation may not pass through or stand in the work area during appliance assembly.
- The serial plate provides important technical information. This is vital in case of a request for maintenance or repair of the equipment: please do not remove, damage or modify it.
- Failure to follow these regulations may cause damage or even fatal injury, subsequently invalidating the guarantee and relieving the Manufacturer of all liability.

Symbols used in the manual



Important warning, if disregarded it can lead to serious damages to the appliance and injuries to people.



Reference to another chapter where the subject is dealt with in more detail.



Manufacturer's advice

The company cannot be held liable for any print or transcription errors, reserving the right to make changes where deemed suitable without prior notice.

Partial reproduction without the manufacturer's consent is prohibited. Measurements are purely indicative and not binding.

The original language used to prepare this manual is Italian: the Manufacturer is not responsible for any translation/interpretation or print errors.

Transport

► Fig.1.

Fitted with personal protection equipment, transport the appliance to the installation location.

Use suitable equipment, capable of dealing with its weight: persons not involved with the appliance installation may not pass through or stand in the work area during the appliance assembly. During the transport, pay particular attention to passing through openings and/or doors.

Preliminary operations

► Fig.2.

Carefully remove the protective film.

If any glue residue is left on the surfaces, remove it with soapy water but without any corrosive or abrasive products or sharp or pointed instruments.



Check that all the parts making up the oven are in good condition and without any faults or breakages, if that is not the case, contact the Manufacturer for the procedures to follow.

Positioning

► Fig.3.

Install the appliance in a room:

- dedicated and suitable to the cooking of food;
- having adequate air ventilation;
- that complies with the current regulations on health and safety and systems in your country;
- protected from the weather;
- with temperatures between +5° to +35°C maximum;
- having a maximum humidity of 70%.



When choosing the positioning room, take into account that the appliance must be **easy to move** for any extraordinary maintenance: be careful since any brickwork after installation (e.g.: wall construction, door replacement with narrower ones, renovations, etc.) do not hamper movements.

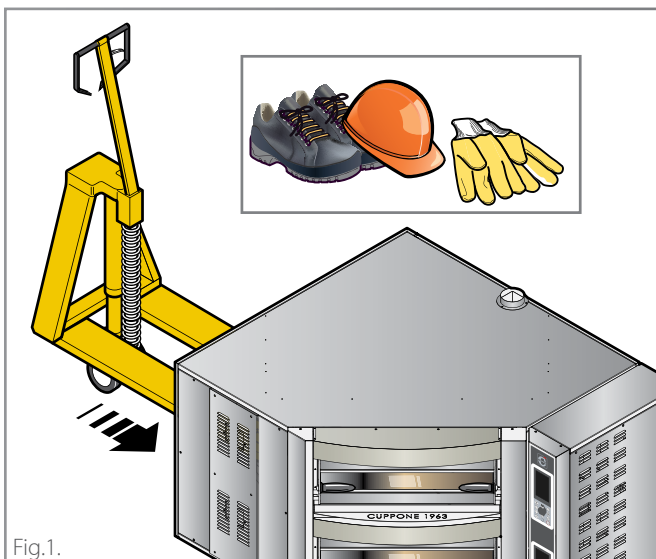

Fig.1.

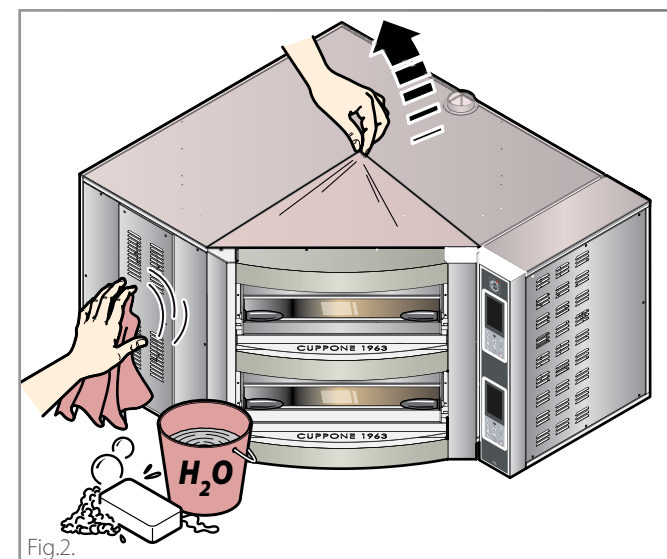

Fig.2.

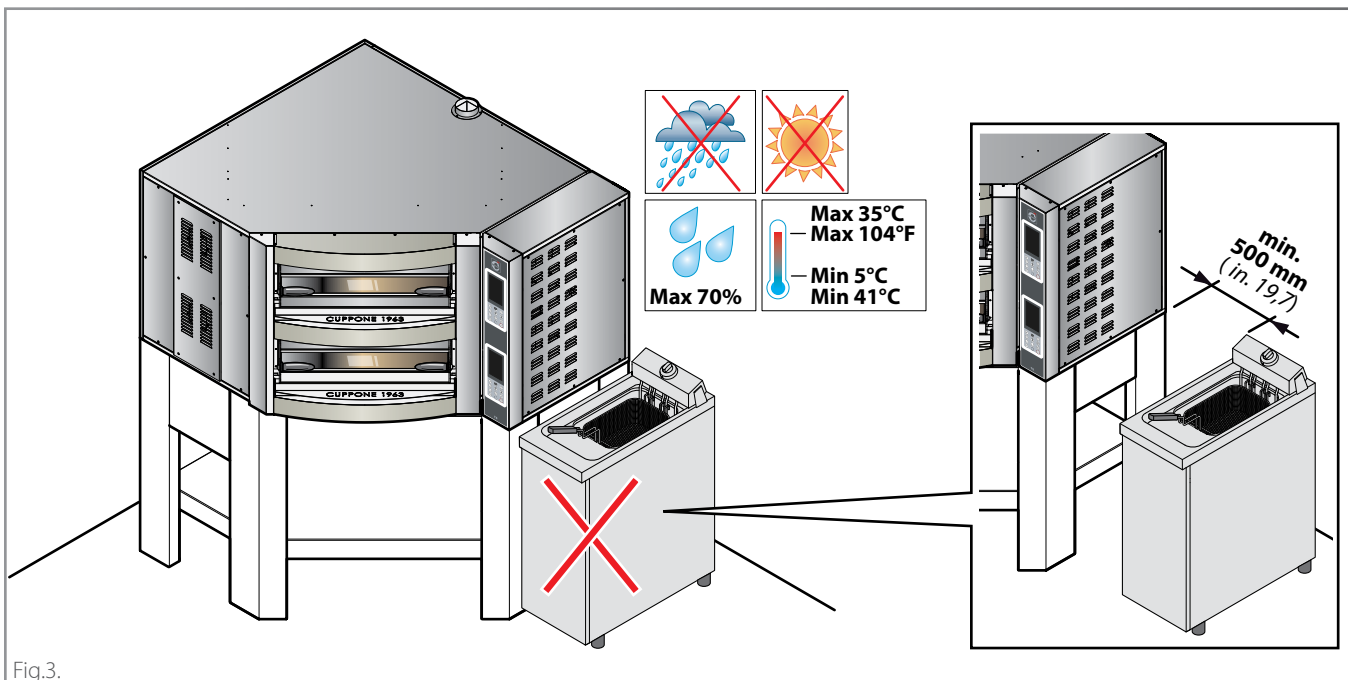

Fig.3.

► **Fig.4.**

Position the appliance on the base provided.

This must:

- be flame and heat resistant;
- be perfectly flat;
- be stable;
- withstand the weight of the appliance.

Caravaggio CR5: net weight 230 kg (single) - 450kg (double)

Caravaggio CR8: net weight 270 kg (single) - 520kg (double)



On request, supports ensuring perfect compatibility with the oven are available from the Manufacturer.

For their correct assembly and fastening to the oven, please refer to the instruction sheet accompanying them.

► **Fig.5.**

Comply rigorously with the following minimum distances of the oven from **walls**, other **appliances**, **objects** and **combustible materials**:

- left hand side: **50 mm**
- right hand side: **500 mm** (to allow easy access to the electrical system; if this is not possible, when required, the oven shall have to be moved from its housing with suitable lifting equipment),
- back: **50 mm**
- top: **1000 mm**



The stated distances must be increased in case of objects or equipment made with heat-sensitive materials.



To reduce the risk of a fire, **comply with the stated minimum distances** and install the appliance in **fireproof** environments that are **not at risk of explosion**. The floor of the installation room must have a surface **fireproof** finish too.

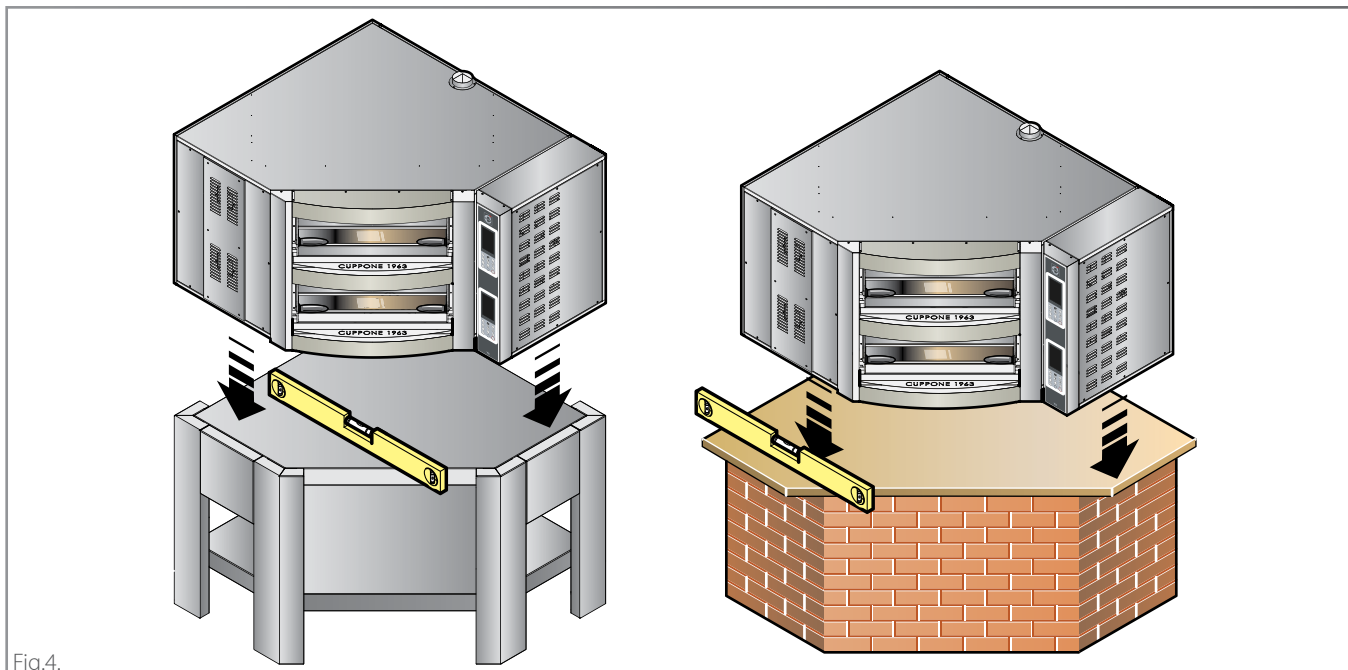

Fig.4.

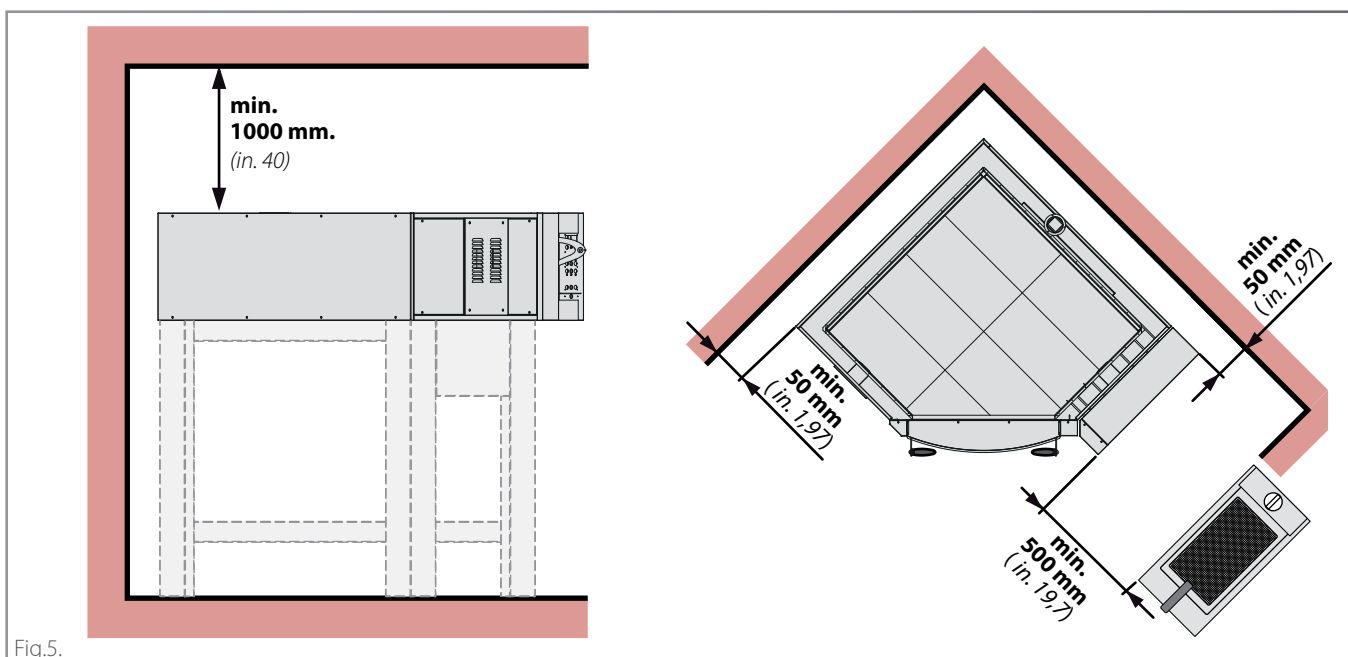

Fig.5.

Serial number plate reading

The serial number is on the right hand side of the appliance. It provides important technical information that is vital in case of a request for maintenance or repair of the appliance: please do not remove, damage or modify it.

Smoke extraction

► Fig.7.

The oven is fitted with an adjustable exhaust in the top to get rid of the steam from the cooking chamber.

This steam, together with the one from the door during the work phases, **must be conveyed outside** in one of the following ways:

- through a **hood supplied by the Manufacturer** that ensures perfect compatibility with the oven. For its correct assembly and fastening to the oven, please refer to the instruction sheet accompanying it.
- through an adequate extraction system supplied by the user: in this case a draught switch must be installed between the extractor and the oven chimney (the extractor and switch are not supplied by the Manufacturer).

The extractor flue must serve only the appliance, have a minimum diameter of **150 mm** and comply with the current regulations.

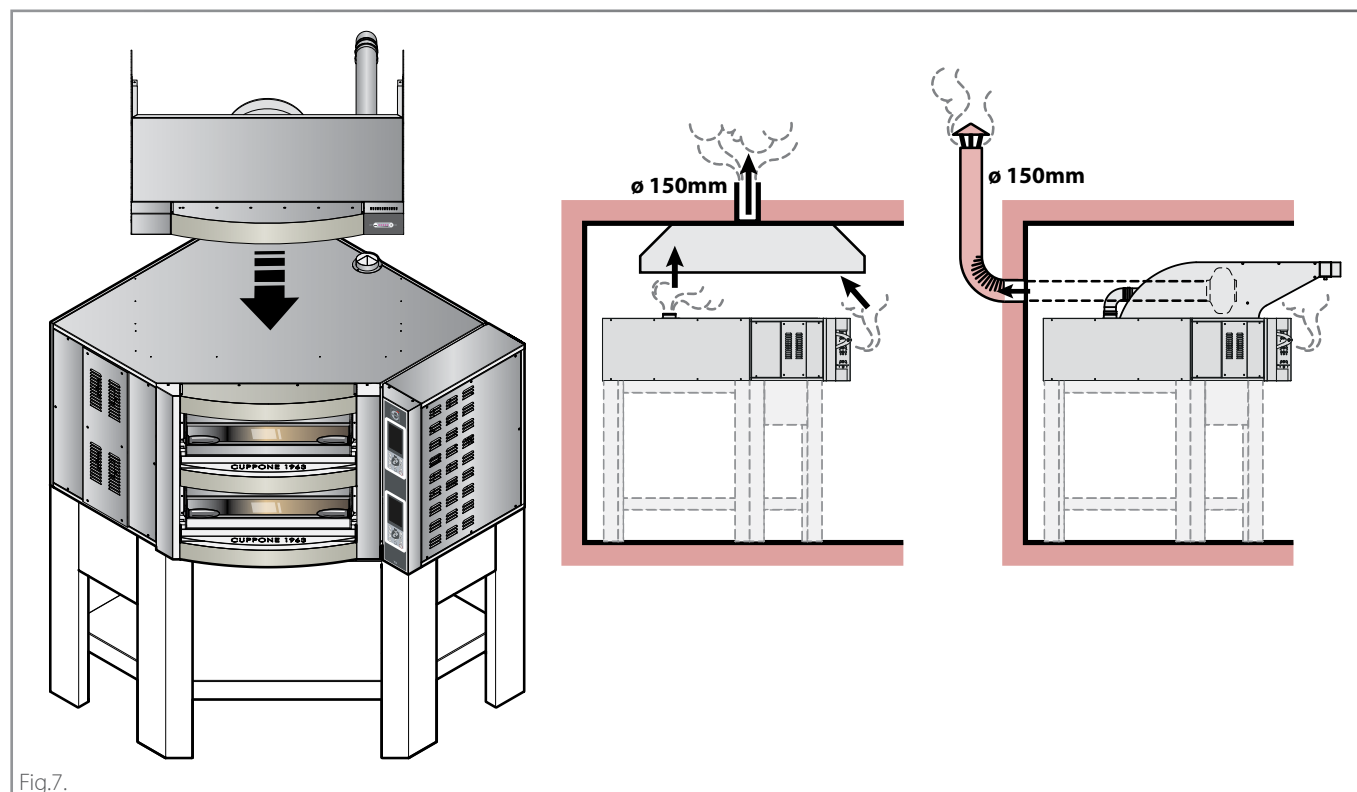
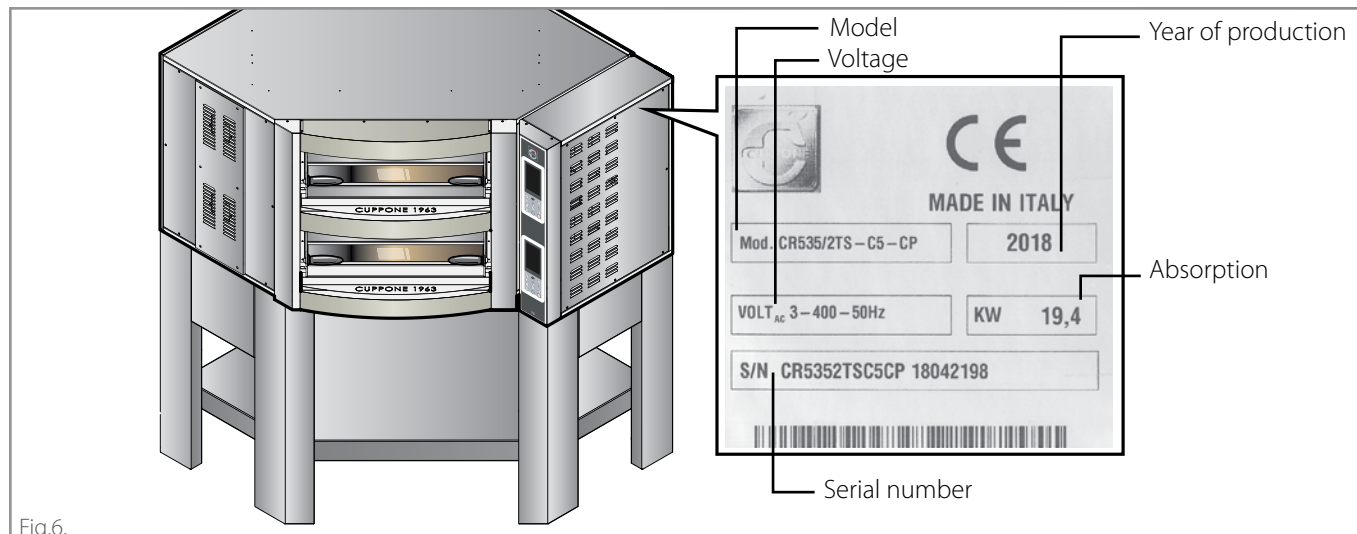

Electrical connection

► Fig.8.

- ⚠ The electrical connection must be carried out **exclusively** by qualified personnel after reading the safety warnings at the beginning of the manual.
- ⚠ Before installing the appliance, **check that systems comply with the regulations in force** in the country where it is going to be used and **with the specifications indicated on the appliance rating plate** on the RH side of the oven.

The appliance is supplied without either power cable or plug: they must both be fitted by qualified personnel. The cable must be only **of the type stated** and the plug fitted to it must be suitable for the consumption and connection of the oven to the electrical mains.

- ⚠ If the oven has a twin chamber, the power cables to be connected are two as the connecting plugs.

Cable type:



CR 5 three-phase Europe (400V) / H07RN-F 5G2,5
 CR 5 three-phase America (208V) / 6/4 SOOW cable
 CR 5 single-phase (230V) / H07RN-F 3G10
 CR 8 three-phase Europe (400V) / H07RN-F 5G4
 CR 8 three-phase America (208V) / 10/4 SOOW cable

To connect the cable to the appliance, remove the RH side panel of the oven, let the cable through the cable gland provided and connect it to the terminal block correctly.

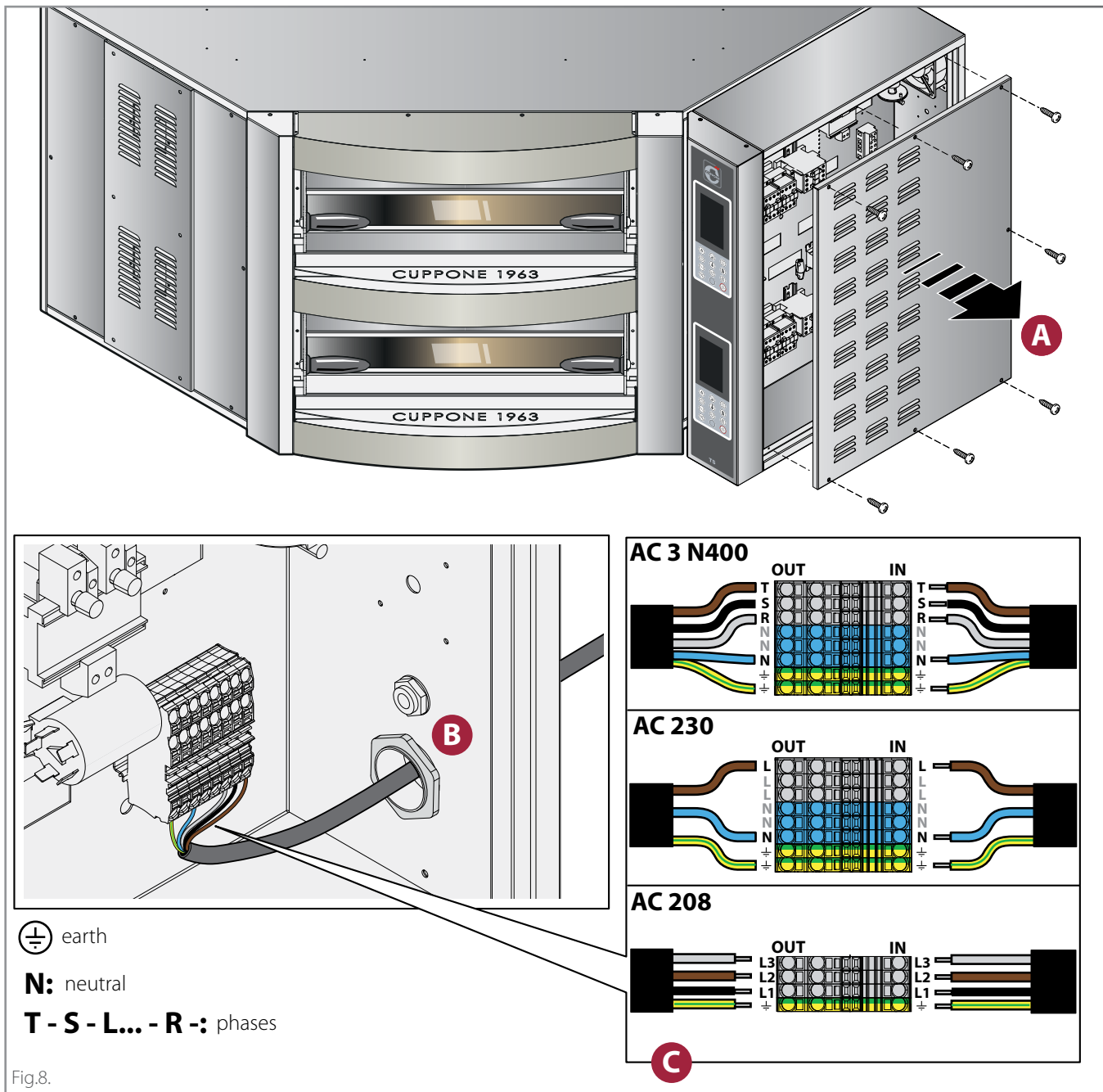
- 📄 The following pages show the electrical diagrams: please refer to the one of the specific model to connect.



For a correct electrical connection, the appliance must:

- be included in an **equipotential system** in compliance with the legislation in force. This connection must be made between the various devices with the terminal marked with the equipotential symbol . The cable must have a maximum cross-section of 10 mm² (in compliance with IEC EN 60335-2-42:2003-09) and must be yellow-green;
- must be **grounded**  to the mains (green-yellow wire);
- must be connected to a **thermal differential switch** in compliance with the regulations in force (0.03 A type);
- must be connected to an **omnipolar circuit breaker** allowing complete disconnection in overvoltage III category conditions.

The Manufacturer accepts no liability for failure to comply with the above.



The cable must be replaced by Cuppone or by its technical assistance service, or in all cases by a person with a similar role in order to prevent any risks.

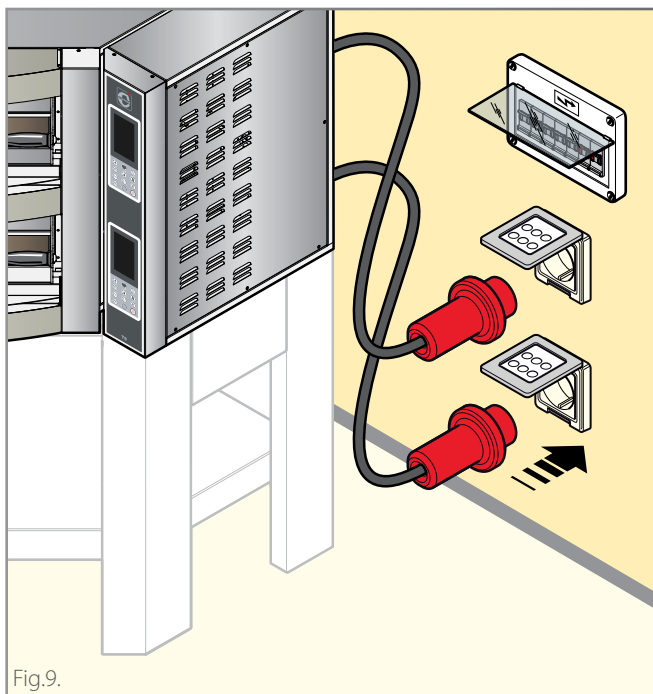

Fig.9.

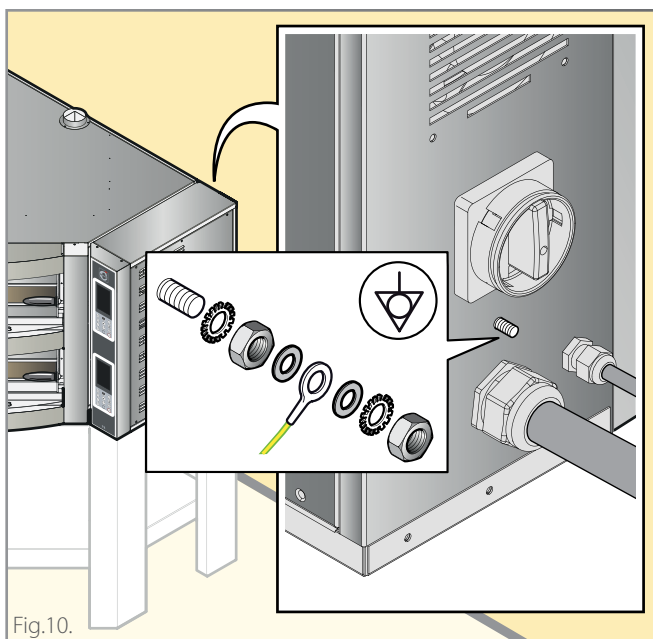
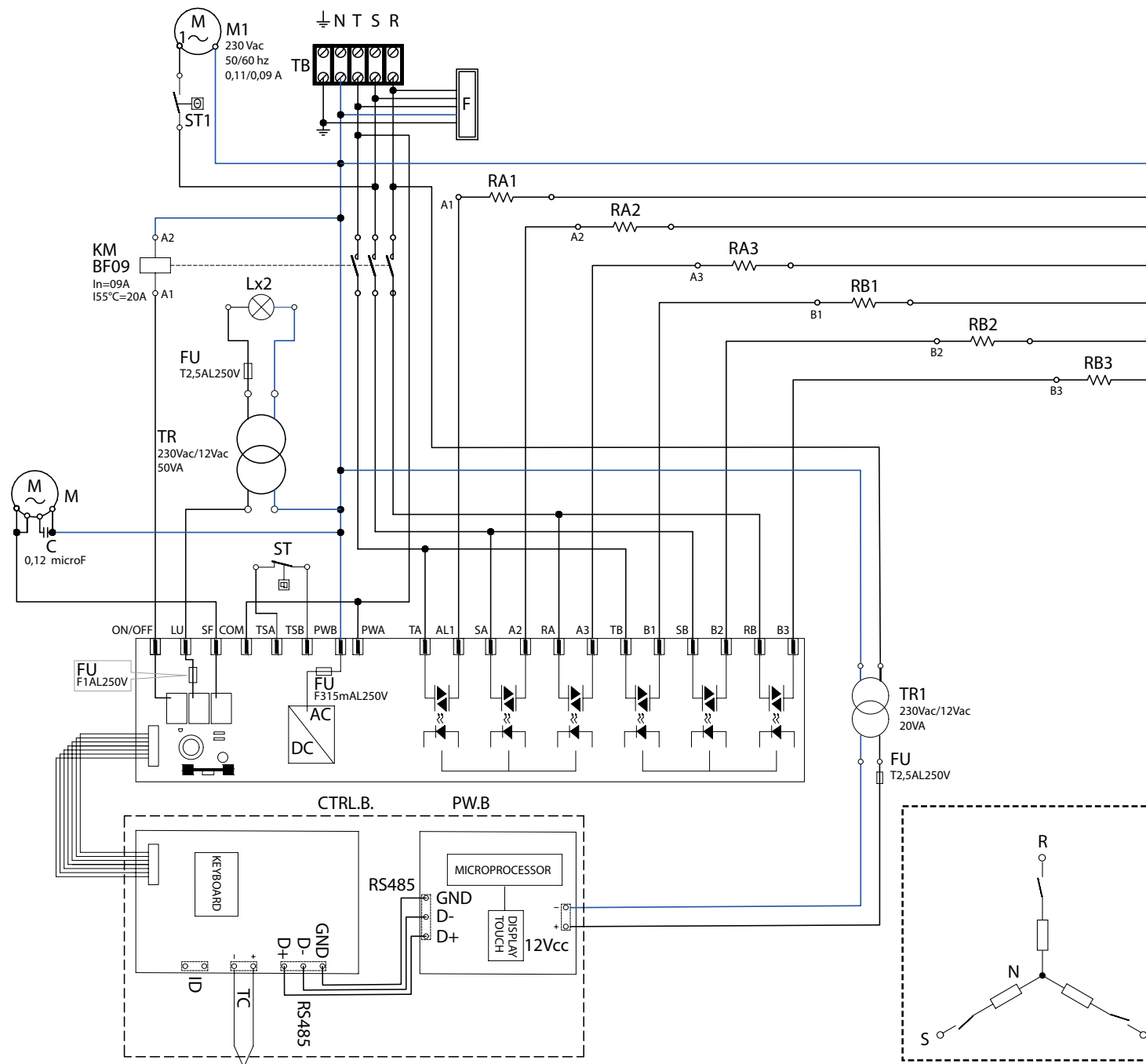
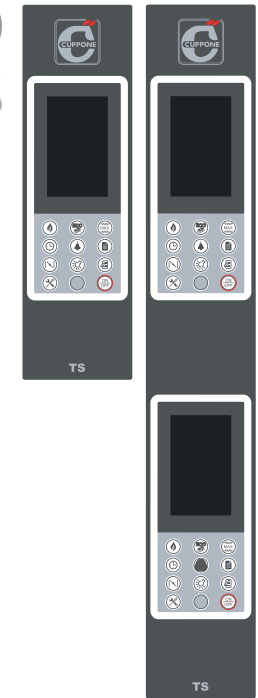

Fig.10.



AC 3 N400 mod. TS



Abbreviation	Description
CTRL.B	Oven control board
C	Motor start capacitor
F	Noise filter
FU	Fuses
ID	Digital input for remote ignition
KM	Contactor BF09-MC09
L	Cooking chamber lights
M1	Board cooling fan motor
M	Chimney opening motor
PW.B	Power board
RA1,2,3	Top resistors
RB1,2,3	Bottom resistors
ST	Safety thermostat
ST1	Cooling fan clickson
TB	Terminal board
TC	Thermocouple
TR	Light transformer 50VA, 230/12Vac
TR1	Transformer 20VA, 230/12Vac

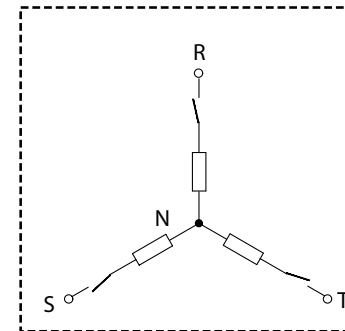

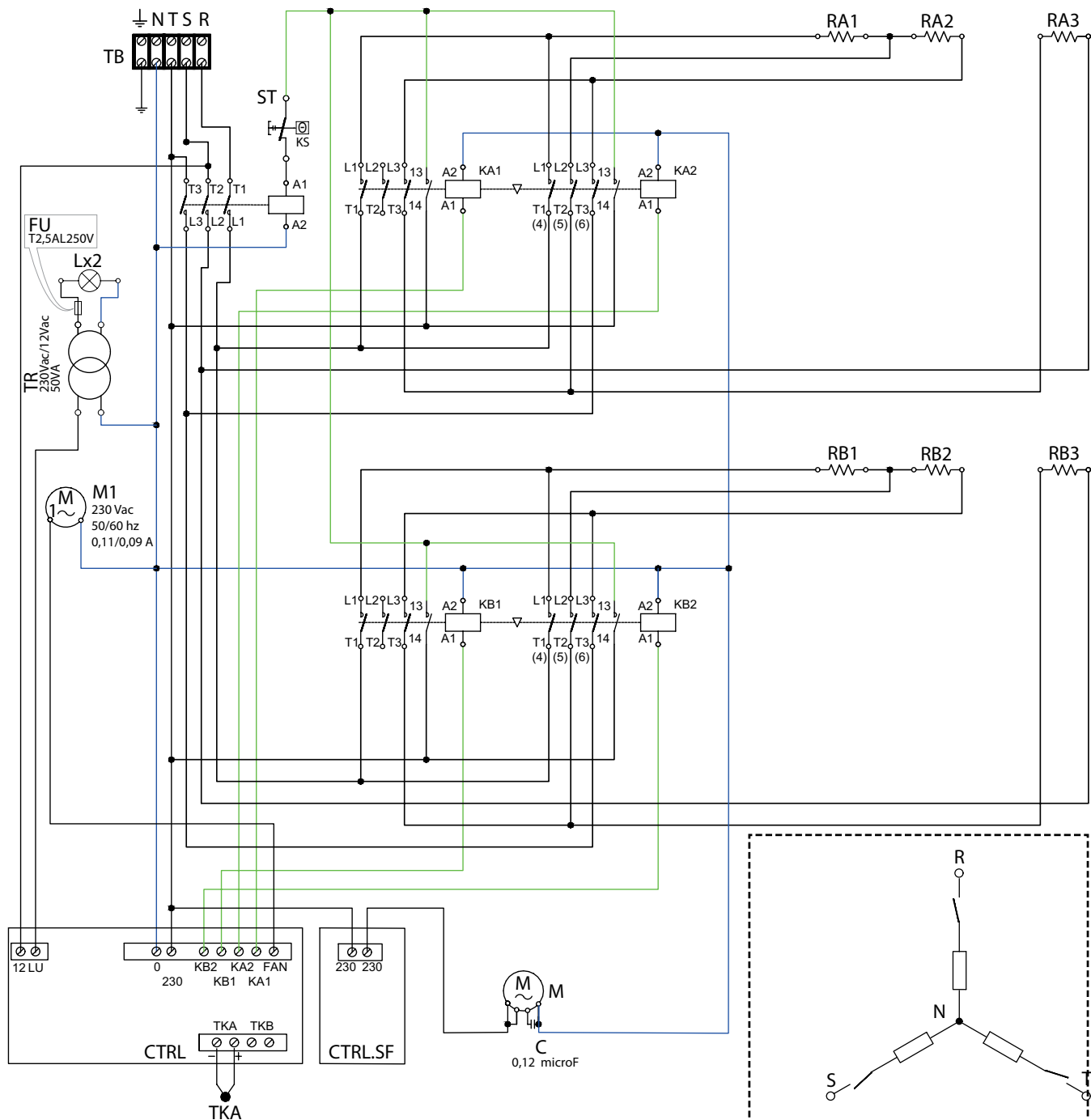

AC 3 N400 mod. CD

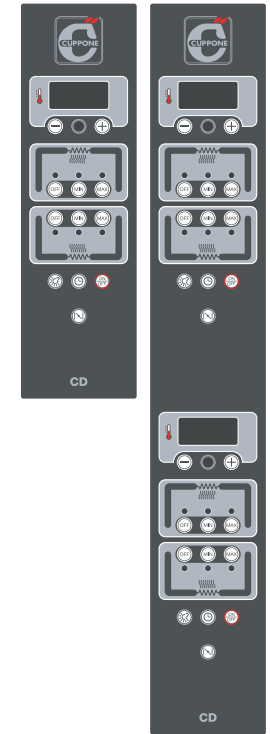

Abbreviation	Description
CTRL	Oven control board
CTRL.SF	Chimney adding board
FU	Fuses
Ks	Safety contactor BF09-MC09
KA1	Top res. half power BF09-MC09
KA2	Top res. full power BF09-MC09
KB1	Bottom res. half power BF09-MC09
KB2	Bottom res. full power BF09-MC09
L	Cooking chamber lights
M1	Board cooling fan motor
M	Chimney opening motor
RA1,2,3	Top resistors
RB1,2,3	Bottom resistors
ST	Safety thermostat
TB	Terminal board
TKA	Top resistor thermocouple
TR	Transformer 50VA, 230/12V AC

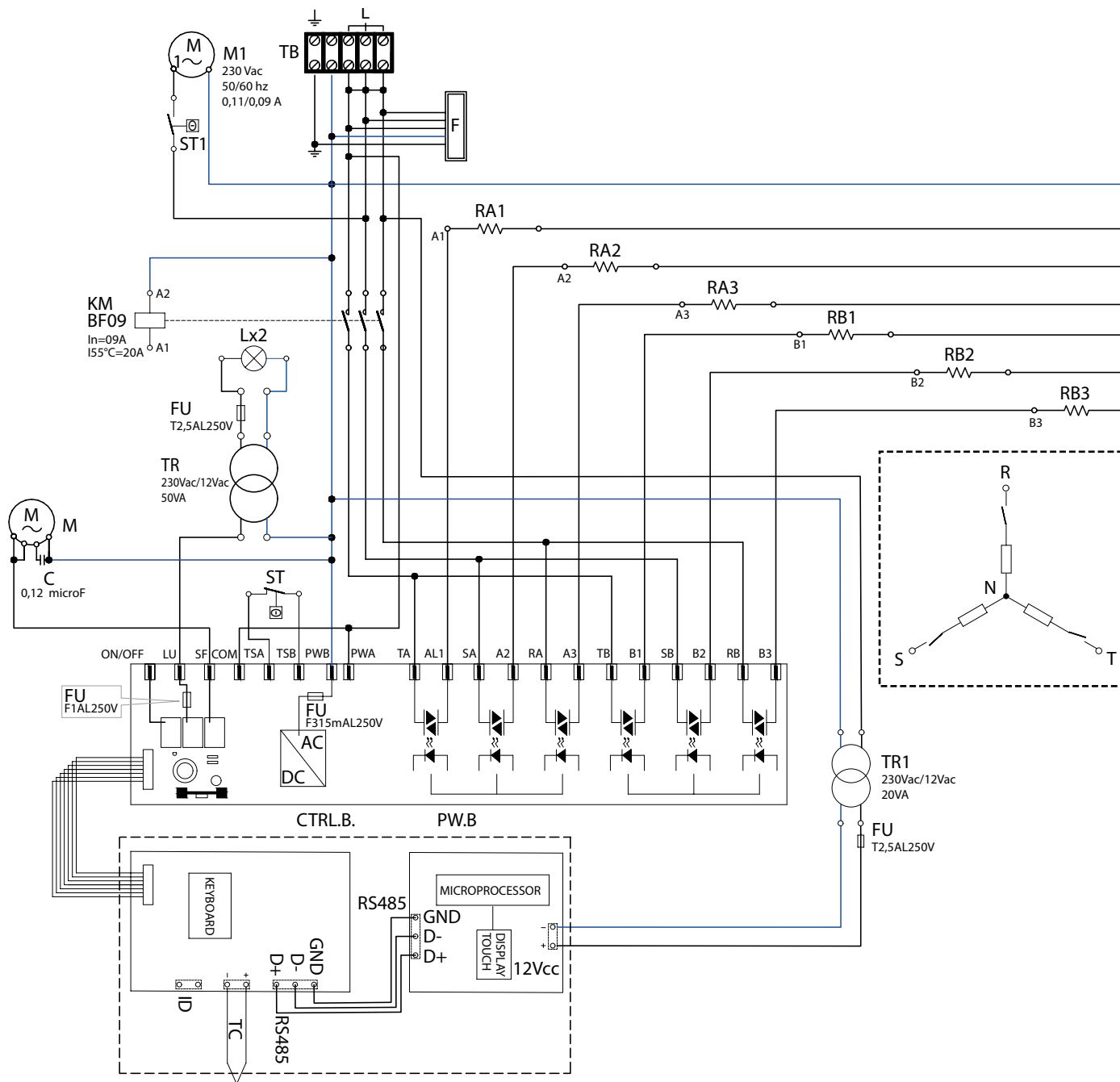

AC 230 mod. TS

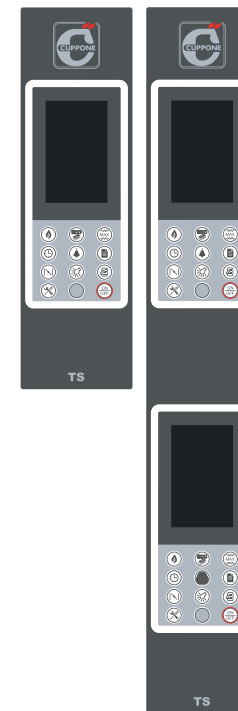

Abbreviation	Description
CTRL.B	Oven control board
C	Motor start capacitor
F	Noise filter
FU	Fuses
ID	Digital input for remote ignition
KM	Contactor BF09-MC09
L	Cooking chamber lights
M1	Board cooling fan motor
M	Chimney opening motor
PW.B	Power board
RA1,2,3	Top resistors
RB1,2,3	Bottom resistors
ST	Safety thermostat
ST1	Cooling fan clickson
TB	Terminal board
TC	Thermocouple
TR	Light transformer 50VA, 230/12Vac
TR1	Transformer 20VA, 230/12Vac

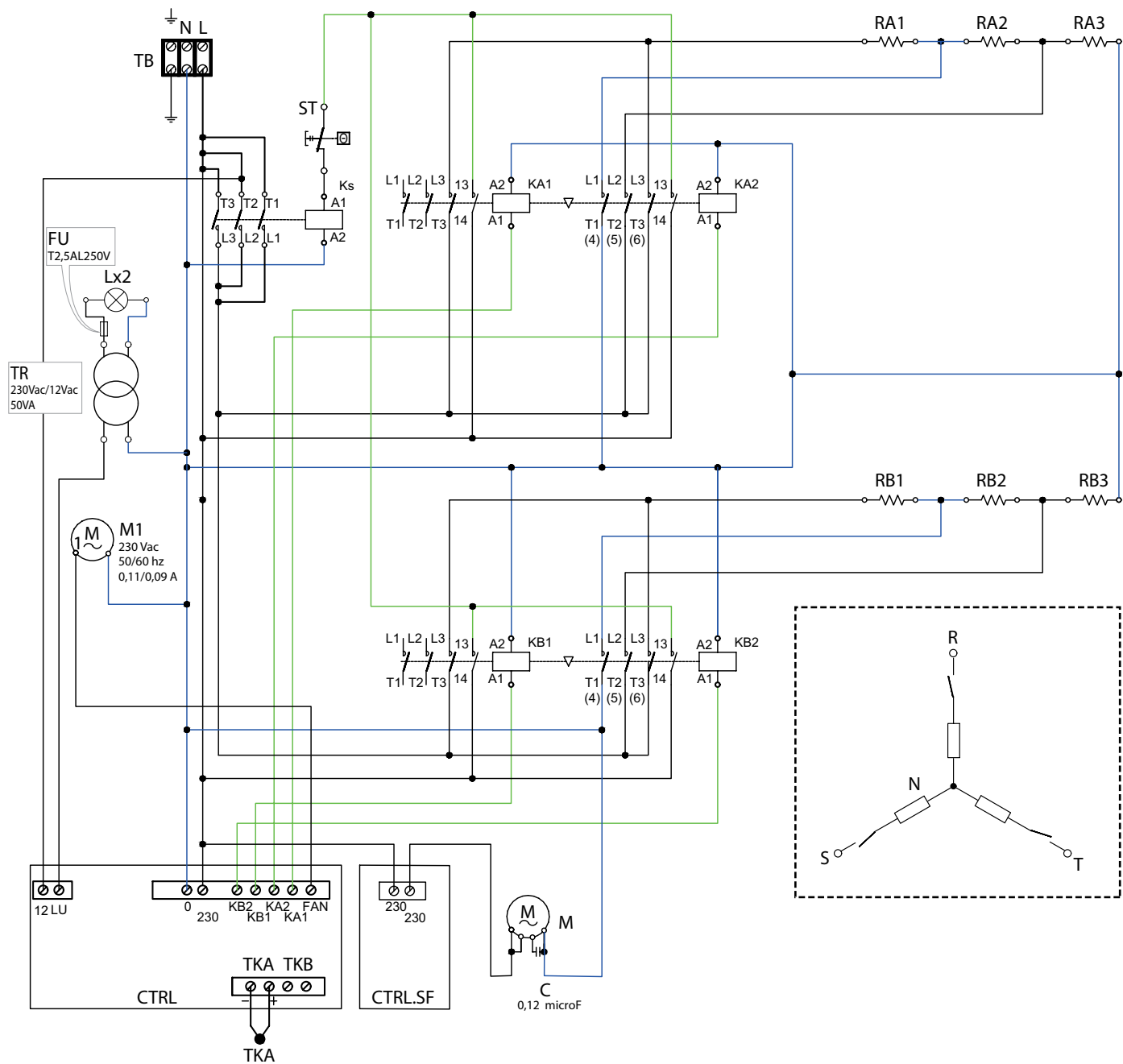

AC 230 mod. CD

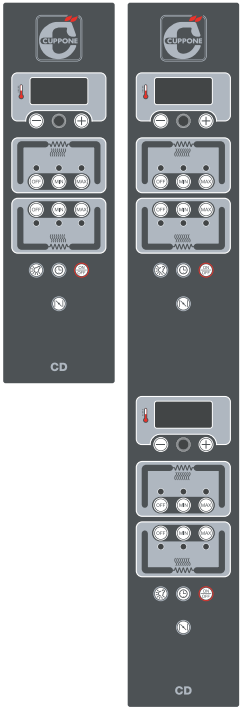

Abbreviation	Description
CTRL	Oven control board
CTRL.SF	Chimney adding board
FU	Fuses
Ks	Safety contactor BF09-MC09
KA1	Top res. half power BF09-MC09
KA2	Top res. full power BF09-MC09
KB1	Bottom res. half power BF09-MC09
KB2	Bottom res. full power BF09-MC09
L	Cooking chamber lights
M1	Board cooling fan motor
M	Chimney opening motor
RA1,2,3	Top resistors
RB1,2,3	Bottom resistors
ST	Safety thermostat
TB	Terminal board
TKA	Top resistor thermocouple
TR	Transformer 50VA, 230/12V AC

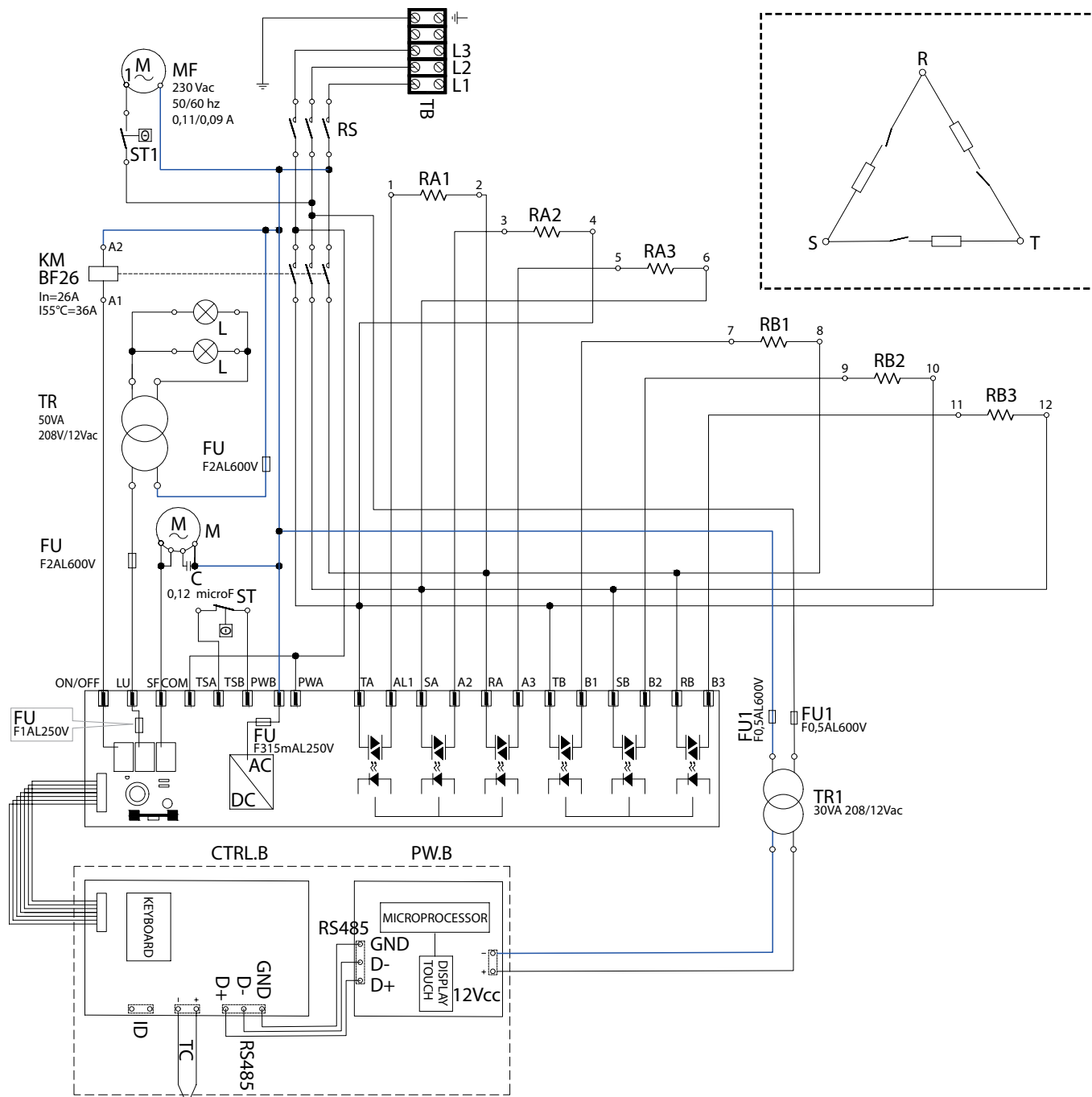

AC 3 208 mod. TS

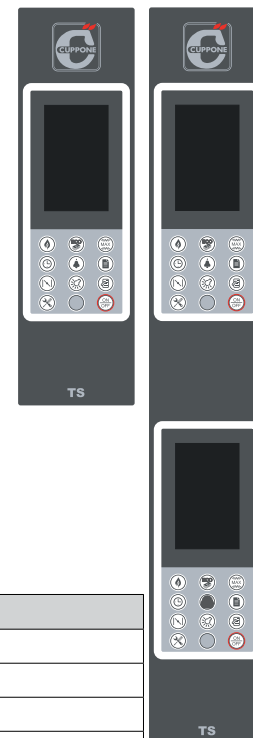

Abbreviation	Description
CTRL.B	Oven control board
C	Motor start capacitor
F	Noise filter
FU	Fuse ULTK 600V 2A
FU1	Fuse ULTK 600V 0.5A
ID	Digital input for remote ignition
KM	Contactor BF26-MC32
L	Cooking chamber lights
MF	Fan
M	Chimney opening motor
PW.B	Power board
RA1,2,3	Top resistors
RB1,2,3	Bottom resistors
RS	Rotary switch
ST	Safety thermostat
ST1	Cooling fan clickson
TB	Terminal board
TC	Thermocouple
TR	Light transformer 50VA, 208/12Vac
TR1	Transformer 30VA, 208/12Vac

Pre-testing and final inspection

Before delivery to the customer, the oven is tested and checked in the Manufacturer's factory.

The "production process sheet" attached to it guarantees that **every** production step, from assembly to packaging, has been carefully checked, both from a functionality and safety point of view.

After installing the appliance, check and mark with a "√" all the boxes of the table on the side: this will confirm the installation is complete and correct.

Checking the operation

Start the appliance following the instructions in the "Use and Maintenance" manual annexed: monitor it during the whole test and check that all the electrical components work properly.

On first startup, set the temperature to a value of **150°C** and keep the oven on for at least **8 hours, without any food inside**: we recommend the chimney is kept fully open during this time.



In this first phase, because of the humidity evaporating from the insulating materials, the oven will give out unpleasant smells and fumes that will gradually disappear during the following operating cycles.

Finish off explaining to the user how to use the appliance in an optimal and safe way and how to carry out ordinary maintenance and cleaning.

√	Positioning checks	Reference chapter on page...
	IS the installation room adequate and compliant with regulations? (correct ventilation, maximum/minimum temperature, etc.)	<u>Positioning</u> on page 5
	Is the appliance perfectly level?	
	Is the appliance resting on the base underneath and is this suitable to support the weight of the oven?	
	Have the minimum distances stated been complied with?	
	HAS the protective film been removed from the surfaces?	<u>Preliminary operations</u> on page 5
	Is the oven chamber free from non-compliant objects (e.g. Installation tools, user manuals, packaging, etc.)? If so, remove them!	
	Is the current chimney flue adequate and does it complies with the current regulations?	<u>Smoke extraction</u> on page 7
√	Electrical checks	Reference chapter
	Does the mains voltage match the data on the rating plate?	<u>Electrical connection</u> on page 8
	Do electric connections meet current regulations in the country of installation and follow the diagrams supplied?	
√	Smoke outlet checks	Reference chapter
	Is the appliance positioned correctly under a suitable hood? We would like to remind you that it is possible to connect the smoke outlet to an extractor (fan or extraction pipe of a motor-driven hood), putting in between the latter and the oven chimney a switch.	<u>Smoke extraction</u> on page 7
√	Miscellaneous	Reference chapter
	Does the user have all the documentation relative to the oven?	-
	Has the user been correctly trained on the use and maintenance of the oven?	-

The company cannot be held liable for any print or transcription errors, reserving the right to make changes where deemed suitable without prior notice.

Partial reproduction without the manufacturer's consent is prohibited. Measurements are purely indicative and not binding.

The original language used to prepare this manual is Italian: the Manufacturer is not responsible for any translation/interpretation or print errors.